



## INFINITI FIREPLACES



*a new generation in heating*



infiniti fires





Photo Courtesy of SA Homeowner

## INFINITI FIRES™ FIREPLACES

The Infiniti range of superior gas and wood fires is the result of extensive research around South African consumer requirements in home heating. A group of fireplace industry specialists believed that a truly South African fireplace product, embodying the best of local and international design and using the best quality raw material available, was possible.

The result, a modern looking range of wood and gas fires that are at the forefront of technology, have striking looks and some of the most efficient combustion systems in the world. Our units are highly advanced in their environmental friendliness, maximising the heat from both gas and wood being burnt, whilst giving very little in the way of emissions into the atmosphere.

We feel sure that in perusing this brochure or visiting us on [www.infinitifires.co.za](http://www.infinitifires.co.za) you will find a fire to suit your specific application. A full list of dealers around South Africa is available on our website, that can assist you further with competent advice, qualified installation crews and after sales service.

## INFINITI GAS FIREPLACES

Infiniti produces both flued and flue-less gas fires. Whether you choose flued or flue-less gas you choose an option packed with advantages.

### FLUED GAS FIRES

Our fires are designed to look as realistic as possible in terms of simulating a real coal or log fire burning. However, in creating this effect they produce a fair amount of carbon monoxide /dioxide which needs to be vented up a chimney.

Generally speaking some 60% of the potential heat from our flued gas fires is lost up the chimney. This is balanced with a zero fume dispersion into the room. This means that our flued gas fires are completely odourless and are the right choice for bedrooms, small rooms or where people are asthmatic.

The construction of our flued unit ensures the most natural looking flame pattern in a non wood burning fire.

Furthermore the firebox allows any of the optional frame styles to be fitted to it, even after construction is complete. This gives the homeowner the flexibility of changing the look of the fire at any time, by changing the frame and door and/or the gas grate.

For the developer, it allows them to build in a standard firebox and fit the frame and grate option selected by the house purchaser on completion of building.

Available in 700mm single sided built in version.

Choice of fuel effect

- Coal / Log or White Pebble

Heating capacity of 3-4kw, 90-130m<sup>3</sup> dependant on model chosen.





## FLUE-LESS GAS FIREPLACES

Flue-less Gas Fires are without a chimney and are therefore considerably more fuel efficient. The design of the fire is such that the amount of carbon monoxide/dioxide produced is minimised to make the fire safe to use without a chimney.

In the INFINITI gas fireplace range, with a uniquely designed combustion system, they reach heating efficiencies of close to 100%. This makes these flue-less fireplace units superb for the economical heating of large spaces. And of course the units are perfect for installation into rooms or houses without chimneys.

## FLUE-LESS GRATES

INFINITI offers the homeowner two grate mechanisms each with their own individual character:

### TRADITIONAL

This is the grate we have made since our inception. The flame exits the burner tray at the front and both sides. It goes through a bed of clinker and has a "fuel effect" on top. The flames are spread through the clinker and fuel effects to cover the grate in flames.

Traditional grates are available in the following fuel effects:

- Large white manufactured stones
- Black coal

Available in wallmount unit only.

## FLAME DANCER™

The Flame Dancer grates are Infiniti's newer grates. They have a flame that exits the grate in a vertical sheet of flame about 100mm high, if left uncovered. The design of the burner creates a flame that dances, hence its name. If covered the flame effect will spread across more of the grate and give a more traditional look.

The Infiniti Flame Dancer grates were designed to give not only stunning modernistic looks but even more importantly, VERY low emissions.

These industry leading low emissions are very beneficial in terms of:

- a virtually odourless grate
- a very safe grate with the lower amounts of Carbon Monoxide/Dioxide produced
- a more efficient grate as more of the carbon in the fossil fuel is converted in the combustion process to usable heat

Flame Dancer grates are available in the following fuel effects:

Burner uncovered

- White or black stone chips around the burner
- Natural white stones around the burner
- Stainless Steel Base plate. This gives an amazing reflection of the dancing flame, fantastic for modern homes

Burner covered

- White or black chips around the burner; natural white stones over the burner
- Natural white stones around and over the burner

700mm size Flame Dancer grates are available in either 5kw or 7kw heating capacities.

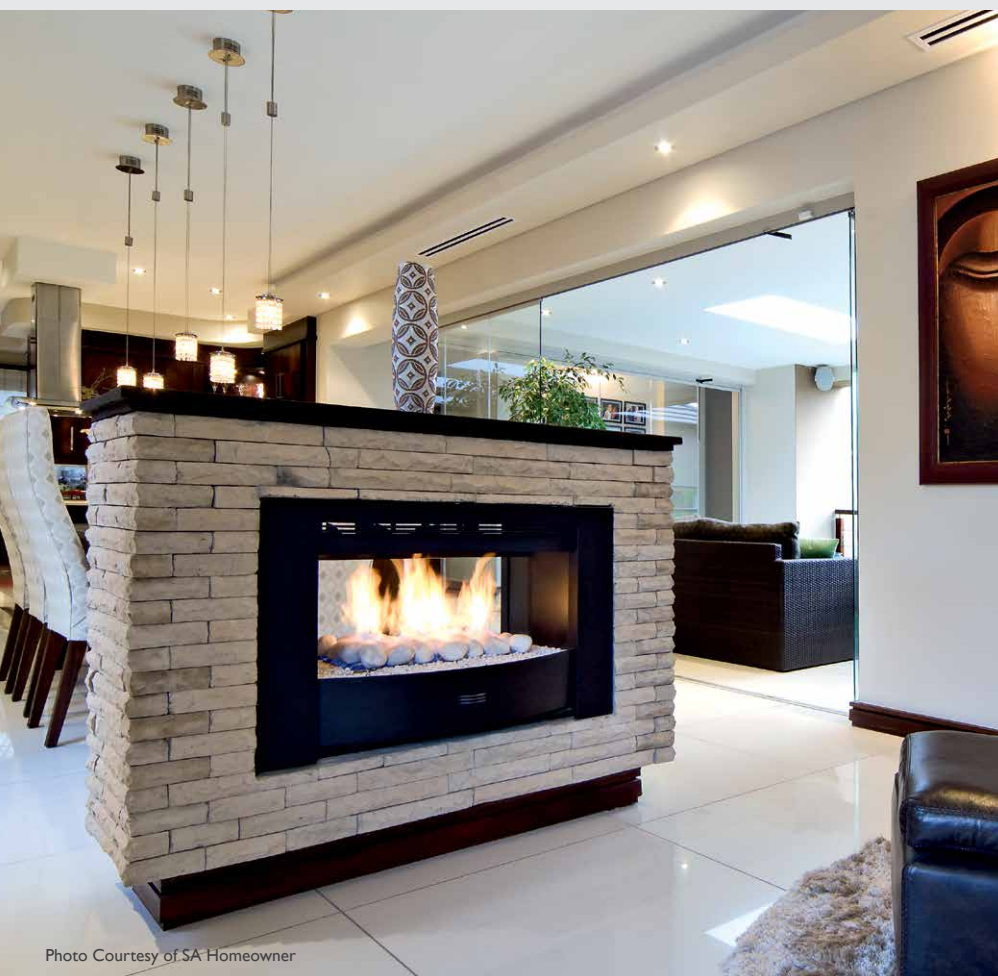

Photo Courtesy of SA Homeowner



INFINITI Stainless Steel WallMount



## FLUE-LESS GAS BUILT IN UNITS

Available as either a single sided or double sided unit.

These units have a steel firebox c/w with a standard 40mm thick black frame. This firebox gets built into your masonry wall.

On completion of building, the grate style chosen, as well as any of the 6 optional trims, can be easily fitted to the firebox.

This gives considerable versatility to the unit in enabling a wide range of looks to suit each person's individual style.

Perfect for the developer, who can build in a standard firebox and later customize this to each purchaser's choice as the units are sold.

Available in 700 or 1000mm size.

Available with Flame Dancer Grate.

Choice of standard frame or any of the 6 optional frames.

Heating capacity of 5 to 10kw, 200 – 400m<sup>3</sup> dependant on model chosen.

## FLUE-LESS GAS WALLMOUNT

This stylish wall mounted fire gives a wonderful feel to a dining room or lounge.

Designed to be installed as a "piece of art" on the wall, it gives a realistic flame, perfect for those dinner parties.

Installation of the Wallmount requires no messy building work or costly alterations. The Wallmount frame bolts firmly to the wall with minimal disturbance to the inside of your home.

This means the installation of the Wallmount is quicker and cheaper than other flue-less fires, most of which require some form of building or structural alteration. This saves time and reduces the material and labour costs related to such alterations.

We recommend the Wallmount unit be installed about 900mm above floor level, maximizing thermal transmission into the room and safely protecting little hands and bodies from the heat of the fire.

The brushed Stainless Steel unit gives a wonderful reflection of the flames, creating that really special look.

Available in black or Stainless Steel.

Available in Traditional Grate.

Heating capacity of 3kw/90m<sup>3</sup>.





## CONCEPT FLUE-LESS GAS

The Infiniti Concept Gas fire is designed to be hung on a wall, or with the addition of a top and bottom section, be installed as a modernistic mantle unit. Ideal for complementing today's more modern architectural styles.

As with our Wallmount unit (see previous page) these units require no messy building work or costly alterations. Instead they simply bolt to the wall to give an easy and time saving installation, without the mess and disruption of building.

This Infiniti unit has a touch panel control switch. Simply press the touch pad located on the top RHS of the unit to switch the unit on or off, or to adjust the flame height. This saves bending down to light the fire, so typical of most manual control valves.

The top and bottom sections of the mantle are available in a choice of 3 colours. If you want your own colour scheme these sections can be over painted by your installer to your individual requirements.

Available with Flame Dancer grate.

Heating Capacity 5-7kw, 200-300 m<sup>3</sup> depending on model chosen.

## TOUCH PANEL CONTROL SWITCH



## CHOICE OF COLOURS



Copper

Brown

Red



## DROP IN GRATE – MODERN STYLING AT ITS BEST

Our drop in grates are designed to simply drop into a hole in a slab, very much like a kitchen hob drops into the kitchen counter:

The slab can be made out of any non combustible material; concrete, granite, marble, etc. to enable you to make a fashion statement to suit your home.

It is imperative for the grate to function, that there is an adequate air supply to the underside of the slab. All our Drop in Grates are provided with a louvre for you to build into the brick structure to allow the required amount of air in.

- Available as standard in 700 or 1000 size
- Available as specials with variable length & depth
- Available in black or brushed stainless steel
- Black unit is supplied with natural white stones to enable you to cover the grate in stones if so desired
- Grates can be fitted flush with slab surface or recessed into it to give different looks
- Available with Flame Dancer grate

### Heating capacity

- |                   |         |                       |
|-------------------|---------|-----------------------|
| • Standard Models | 5-10kw  | 200-400m <sup>3</sup> |
| • Special Models  | 10-15kw | 400-600m <sup>3</sup> |

Black Drop In



Stainless Steel Drop In



Black Drop In Covered with Stones



Recessed Black Drop In Covered with Stones







Photo Courtesy of SA Homeowner

INFINITI 700 Double Sided Flue-less Gas Fire with Wraparound Black Frame



## CONVERSION GRATE – THE EASY WAY TO CONVERT AN EXISTING INEFFICIENT FLUED GAS FIRE TO A HIGHLY EFFICIENT FLUELESS

These grates are designed to enable the easy conversion of an existing steel or brick fireplace into a flue-less gas fire. If you have an open wood or anthracite burning fire it is as simple as sealing up the chimney opening to prevent heat loss up the chimney, running gas to the fire and connecting up our flue-less grate.

No more lighting of fires, no more smoke smell in the house, no more cleaning out the ash. Simply large quantities of heat with the convenience of a flick of a switch.

If you have a flued gas fire it is even easier. Remove the flued grate, seal up the chimney flue and fit the flue-less grate to the existing gas line. Generally a 1 to 2 hour job.

Our flue-less grate is 3 times more efficient than most flued grates. That is either a lot more heat for your house at no extra cost or the same heat with a big reduction in running cost. Plus, you will be doing your bit for our environment by utilising our gas reserves in a more beneficial manner.

- Available in 550, 700, 850 and 1050mm size
- Available with Flame Dancer Grate

Heating capacity 5-10kw, 200-400m<sup>3</sup> depending on model chosen.

## SAFETY COMES FIRST



**INFINITI gas fires are equipped with flame failure devices. This ensures that the gas supply is automatically switched off should the pilot light cease burning. INFINITI flue-less gas fires also have an oxygen depletion sensor which will switch off the fire if it detects a low level of oxygen in the room.**

These safety devices make these units very safe to use. As flue-less gas fires consume oxygen and produce Carbon Monoxide/Dioxide, adequate air supply is essential to ensure peak performance from them. Please refer to the table on the last page of this brochure detailing the minimum room size our flue-less appliances should be installed in.

It is ideal that some ventilation occur, either in the form of air bricks or gaps around doors/windows, so that fresh air can be introduced and stale air removed. Chat to the salesman or gas installer you are using regarding the requirement for your application. See table on rear page containing information on minimum room sizes and ventilation requirements.

It is illegal to install any flue-less gas fire in a bedroom or bathroom. In the event you wish to install one of our fires in a bedroom or bathroom a flued gas fire must be used.

INFINITI flue-less gas fires have recorded CO/CO<sub>2</sub> ratios of approximately 4 to 50% of the maximum legal/safe limit set by the authorities in South Africa. These low figures put them at the forefront of technology in South Africa, which guarantees not only their safe usage but also a virtually odourless operation, an essential component of a superior flue-less gas fire.

It is legal requirement that all gas appliances be installed by a gas installer registered by SAQCC-Gas. Please verify that your installer is registered by asking to see his "drivers licence" style registration card.



INFINITI 8kw Cube



INFINITI 8kw c/w legs

## WOOD STOVES

The ever increasing price of electricity has pushed the cost of heating a home by electricity to unsustainable levels. This coupled with increasing awareness of the importance of preserving the environment, has led to a demand for a cost effective way of heating homes, that is environmentally aware. Wood stoves have been used in Europe for the last 150 years as a much more efficient source of heat. These remarkable units are designed to burn wood slowly, with minimal emissions into the atmosphere and lots of heat.

Infiniti Fires has extended its range of wood stoves to encompass:  
8 & 12kw freestanding units.  
8, 10 & 12kw Built In (Insert) units.

When buying wood in bulk (Typically 1 ton loads) these units will provide heat at about **25c per kwhr**, one quarter the price of electricity & one seventh the price of Flueless gas appliances.

## 8KW CUBE

This freestanding unit comes standard with 80mm high legs and a conversion plate. By simply removing two screws and fitting the conversion plate, the unit can be changed to create a cube effect.

These units can be installed either sitting on floor tiles or a hearth, or can be installed on top of our wood storage table or our low table, thereby creating a range of looks from the same unit.

The units all have rear heat deflector plates, enabling them to be installed 150mm off plaster walls. A snug fit for best look.

Heating capacity of 8kw / 320m<sup>3</sup>.





## SPECIAL FEATURES OF OUR WOOD STOVES INCLUDE:

A full vermiculite jacket inside the fire. This insulating material raises the combustion temperature inside the fire to in excess of 950°C. At these temperatures the wood burns highly efficiently sending very little emissions into the atmosphere. The high temperature combustion sends about 70% of the heat of the fire out through the glass door as an infrared light wave. This enables the heat to travel long distances across the room and keeps the heat down where you want it, particularly important in open plan/double volume spaces.

A long, slow burn time so that the fire can comfortably burn through the night or whilst we are out during the day. We have found that with a full load of good quality wood, the 8kw stove can burn at slow pace for up to 12 hours and the 12kw stove up to 15. Feats hitherto unheard of on any wood stove sold in South Africa.

## 12KW WOOD STOVE

This 12kw wood stove has sold for the last five years in South Africa. Its powerful heat output is capable of heating 500m<sup>3</sup> of home, making it a great seller into today's open plan homes.

The unit is available as standard in black or for that more sophisticated look, with stainless steel legs. A modern looking powerhouse suited for today's open plan homes.

Heat capacity 12kw / 500m<sup>3</sup>



INFINITI 12kw Wood Stove c/w Stainless Steel Legs



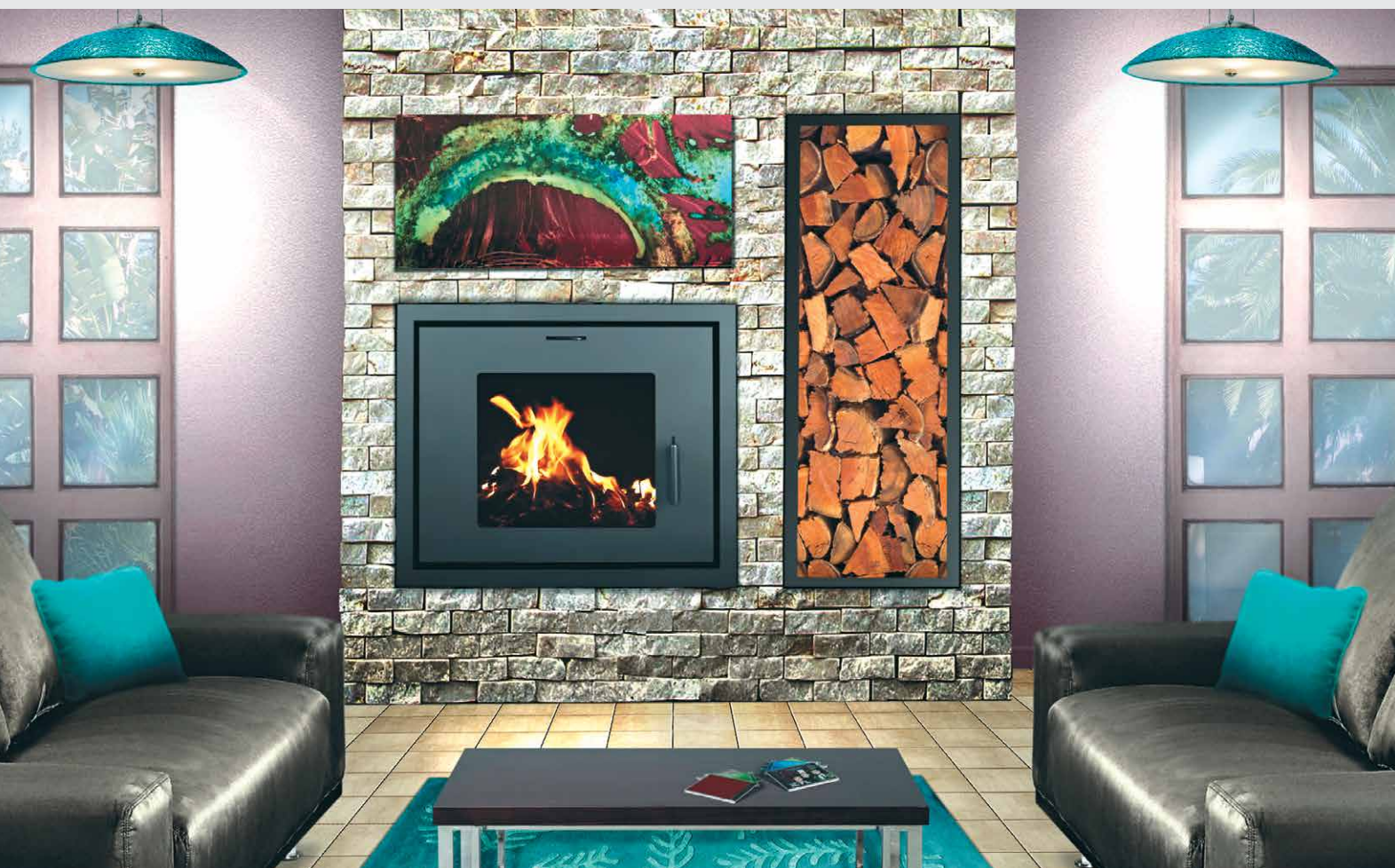

## WOOD INSERTS

Infiniti's wood stoves are available as inserts. Using the same tried and trusted fireboxes as the freestanding units, these models are designed to be built into brickwork to give you that swisher look.

They are manufactured with a built-in convection system. This funnels air around the outside of the hot firebox, bringing it back into the room as hot air. This increases the efficiency of the unit to just below that of the freestanding unit.

They are ideal for those existing homes that have a brick chimney as well as for new homes/renovations where chimneys are to be built.

With the same high temperature combustion and long burn times of the freestanding units, these inserts are capable of heating large areas of home.

Available as standard with a 40mm black frame.

Available in the following versions:

Unit	Heat (Kw)	Heat (m <sup>3</sup> )
Single Sided Insert	8kw	320
	10kw	410
	12kw	500
Double Sided Insert	12kw	500



INFINITI 10kw Insert





Insert being slid into 700 Double Sided Universal



Completed Look

## CONVERSION WOOD INSERTS

These Infiniti Inserts are designed to convert existing built-in Jetmaster 700D and 700 Double Sided Universals to high efficiency wood stoves; capable of economically heating large areas.

By using a cutting torch to cut away the internal parts of the existing Universal, you are able to slide our insert into the external remains of the Universal. Our steel frame covers up to the external dimensions of the existing Universal frame to give a tidy fit.

This means our insert can be completely installed in less than a day without any damage or re-work to the walls around the existing Universal. This saves a lot of dust and disruption to the room as well as minimising the costs of changing to our powerful insert.

Available in the following versions:

Unit	Heat (Kw)	Heat (m³)	Converts
Infiniti Single Sided	10kw	410	Universal 700D
Infiniti Double Sided	12kw	500	700 Double Sided

## GAS FIRES BUILT IN UNITS

### THE INFINITI CHOICE MAKE IT THE WAY YOU WANT IT

#### Fire Box Choices:

- 700 size - Flued (chimney) gas fire
- 700 or 1000 size - Flue-less gas fire, single or double sided

#### Frame Choices:

- Standard 40mm frame - Black
- Deluxe frame - Black or Stainless Steel
- Extra Wide frame - Black or Stainless Steel
- Wraparound frame - Black or Stainless Steel

#### Grate Choices:

##### Flued

- Coal / Log or white pebbles

##### Flue-less

- Traditional
- Flame Dancer

## FLUED GAS FIRE BOXES SINGLE SIDED BUILT IN

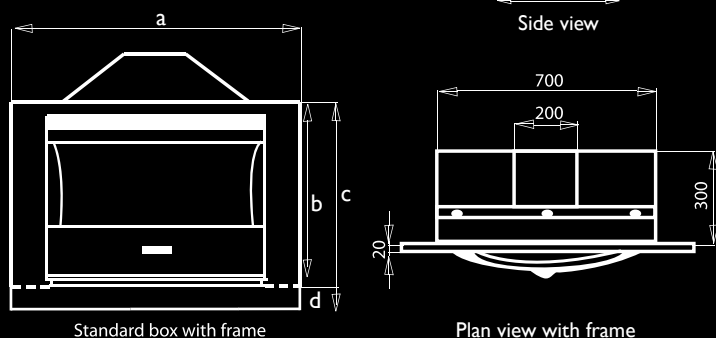
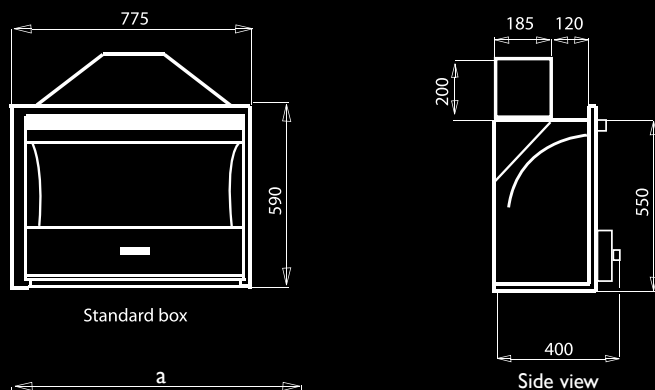

700 Box Size	a	b	c	d
Standard Box	775	590	590	0
Deluxe Frame	935	595	595	0
Extra Wide Frame	1190	595	595	0
Wraparound Frame	1165	618	672	54
1000 Box Size not Available				

## FLUE-LESS GAS FIRE BOXES SINGLE SIDED BUILT IN

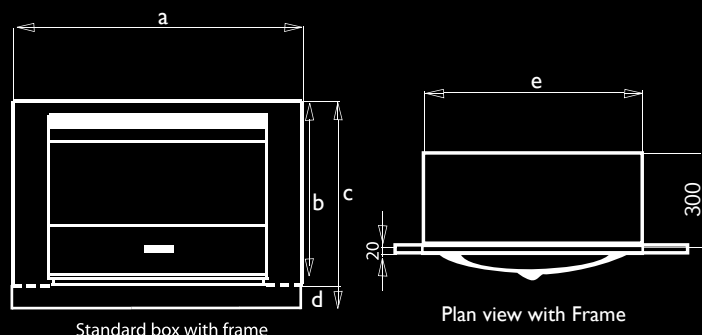
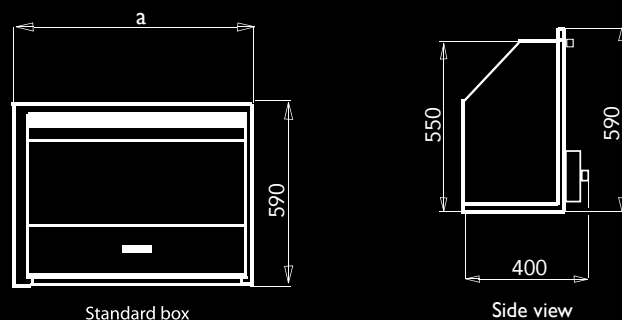

700 Box Size	a	b	c	d	e
Standard Box	775	590	590	0	700
Deluxe Frame	935	595	595	0	700
Extra Wide Frame	1190	595	595	0	700
Wraparound Frame	1165	618	672	54	700
1000 Box Size	a	b	c	d	e
Standard Box	1075	590	590	0	1000
Deluxe Frame	1238	598	598	0	1000
Extra Wide Frame	1455	621	621	0	1000
Wraparound Frame	1460	621	675	54	1000

## DOUBLE-SIDED BUILT IN

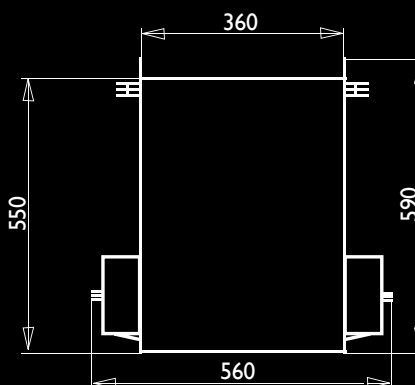

#### Side View

For front dimensions refer to  
Flue-less Gas Boxes



STYLING CHOICES

Standard Black



Deluxe Black Frame



Extra Wide Black Frame



Wraparound Black Frame



Deluxe Stainless Steel



Extra Wide Stainless Steel



Wraparound Stainless Steel



WALLMOUNT FIRE

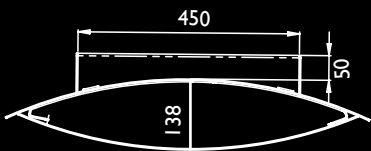

Plan view

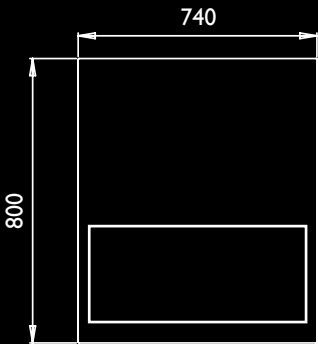

Front view

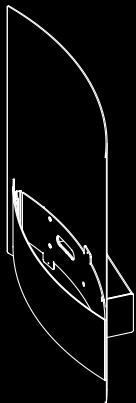

GAS DROP IN GRATE

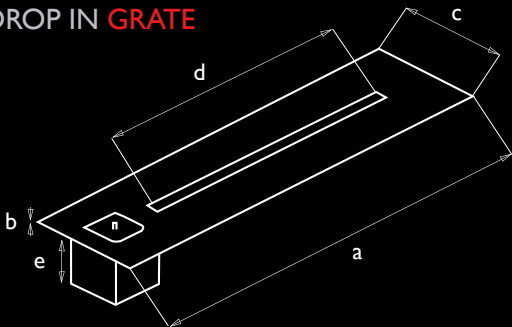

Grate Size	a	b	c	d	e	Size of cut out for grate to drop into
700	880	5	200	470	170	170mm x 840mm
1000	1100	5	200	700	170	170mm x 1060mm
Special dimensions a & c variable	Variable	5	Variable	940	170	Variable
	Variable	5	Variable	1400	170	Variable

GAS CONVERSION GRATE

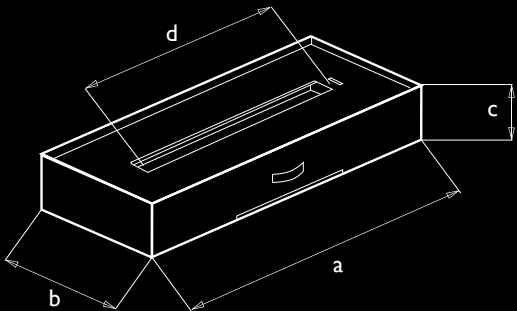

Grate Size	a	b	c	d
550	535	285	160	470
700	685	285	160	470
850	835	285	160	700
1050	1035	445	160	700

CONCEPT WALLHANGING

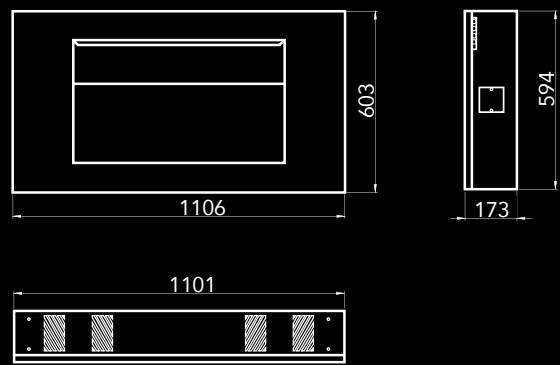

CONCEPT MANTLE

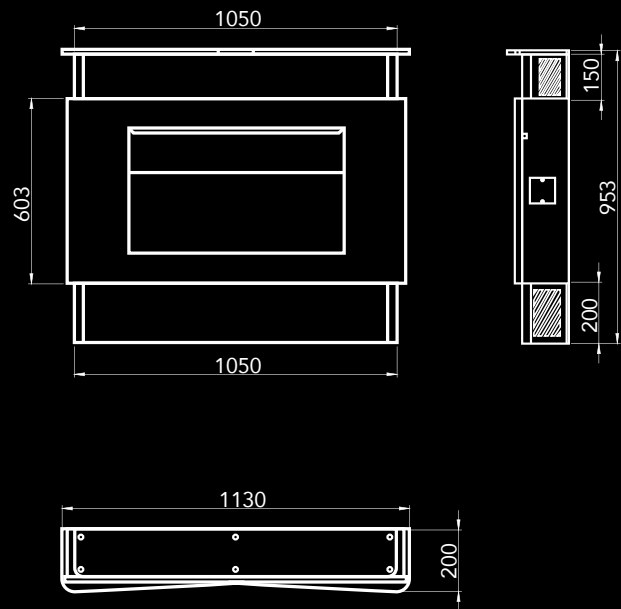

WOOD STOVES

8KW CUBE

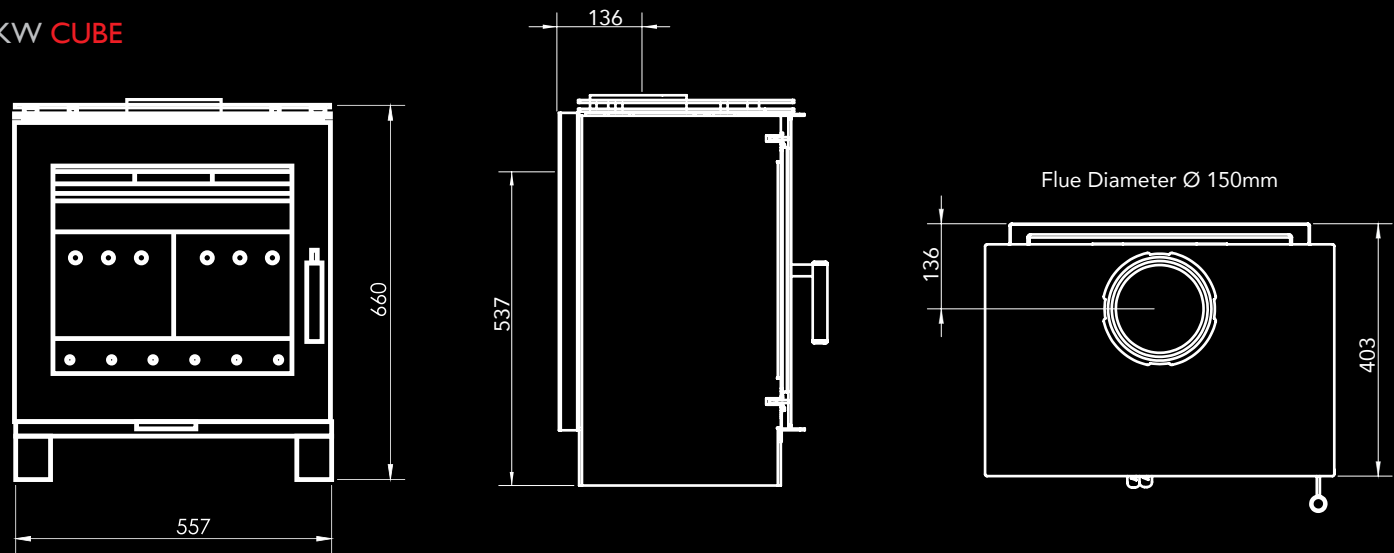

12KW WOOD FREESTANDING

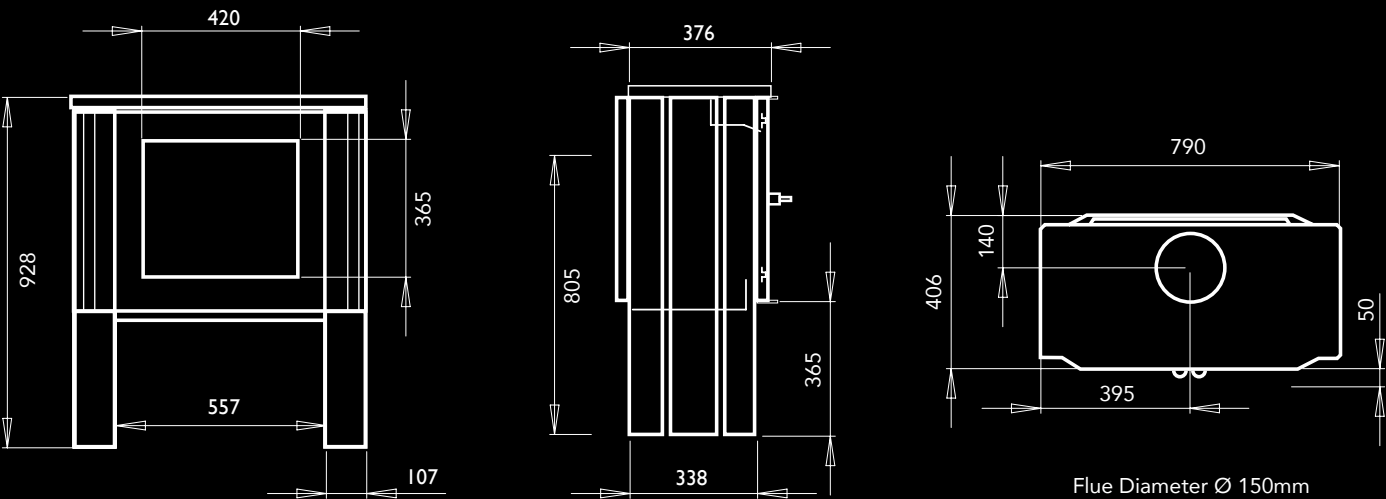



## WOOD TABLE

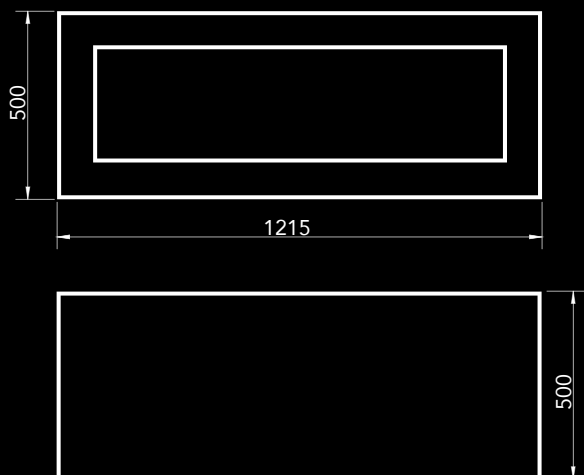

## LOW TABLE

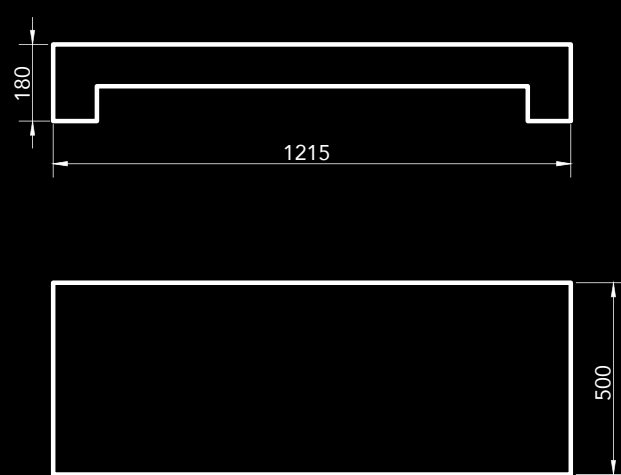

TABLES MADE IN BLACK STEEL

## WOOD INSERTS

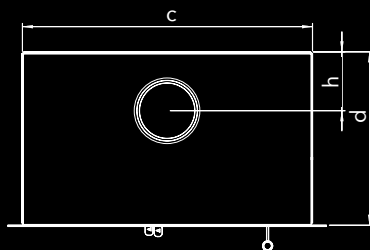

### FRONT VIEW

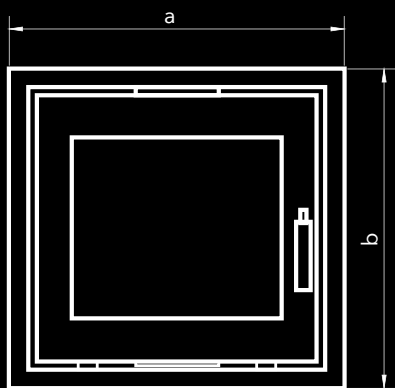

### SINGLE SIDED

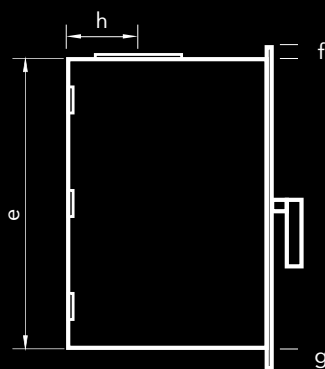

### DOUBLE SIDED

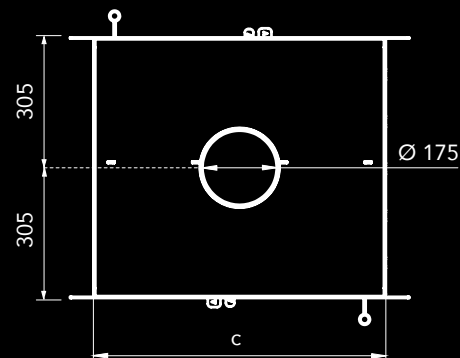

Product	a	b	c	d	e	f	g	h	Flue diameter
<i>Single Sided Units</i>									
<i>New Builds</i>									
8kw	671	640	602	405	582	22	36	149	150
10kw	750	630	684	405	562	34	34	138	150
12kw	805	669	734	405	599	35	35	149	150
<i>Conversion Units</i>									
10kw	800	700	684	405	562	63	75	138	150
<i>Double Sided Units</i>									
12kw (New Build)	750	630	690	609	562	34	34	N/A	175
12kw (Conversion Unit)	800	700	690	609	562	63	75	N/A	175

## GAS FIRES

UNIT	Heat Output	Heating Capacity	Gas Consumption		Legal Minimum Room Size	Cross Ventilation Required *
			g/hr			
	Kw	m³	Lo	Hi	m³	cm²
700 Flued Gas Single Sided						
White Pebble	3 Kw	90	450	700	N/A	N/A
Coal	4 Kw	120	400	600	N/A	N/A
Log	4 Kw	130	400	750	N/A	N/A
Flue-Less Gas Single Sided						
700 Flame Dancer 200 Grate	5 Kw	200	150	300	60	2x 98
700 Flame Dancer 300 Grate	7 Kw	300	250	490	98	2x 160
1000 Flame Dancer Grate	10 Kw	400	450	740	148	2x 240
Flue-Less Gas Double Sided						
700 Flame Dancer 200 Grate	5 Kw	200	150	300	60	2x 98
700 Flame Dancer 300 Grate	7 Kw	300	250	490	98	2 x 160
1000 Flame Dancer Grate	10 Kw	400	450	740	148	2 x 240
Flue-Less Gas Wallmount						
Traditional Grate	3 Kw	90	140	210	42	2 x 70
Flue-Less Gas Concept						
700 Flame Dancer 200 Grate	5 Kw	200	150	300	60	2x 98
700 Flame Dancer 300 Grate	7 Kw	300	250	490	98	2 x 160
Flue-Less Gas Drop In Grates						
700 Flame Dancer 200 Grate	5 Kw	200	150	300	60	2x 98
700 Flame Dancer 300 Grate	7 Kw	300	250	490	98	2 x 160
1000 Flame Dancer Grate	10 Kw	400	450	740	148	2 x 240
Special - 940 Burner	10 Kw	400	400	950	190	2 x 310
Special - 1400 Burner	15 Kw	600	600	1200	240	2 x 390
Flue-Less Gas Conversion Grates						
550 Flame Dancer 200 Grate	5 Kw	200	150	300	60	2x 98
550 Flame Dancer 300 Grate	7 Kw	300	250	490	98	2 x 160
700 Flame Dancer 200 Grate	5 Kw	200	150	300	60	2x 98
700 Flame Dancer 300 Grate	7 Kw	300	250	490	98	2 x 160
850 Flame Dancer Grate	10 Kw	400	450	740	148	2 x 240
1050 Flame Dancer Grate	10 Kw	400	450	740	148	2 x 240

\*Cross Ventilation is required if your room is smaller than the legal requirement.

## Wood Stoves

### Free Standing

Cube	8 Kw	320m <sup>3</sup>
12 Kw Wood Stove	12 Kw	500m <sup>3</sup>

### Inserts

8 Kw	8 Kw	320m <sup>3</sup>
10 Kw	10 Kw	410m <sup>3</sup>
12 Kw	12 Kw	500m <sup>3</sup>

## WARRANTY

- 15 Year warranty on built in fireboxes
- 5 Year warranty on wood stoves
- 2 Year warranty on gas grates

Infiniti Fires™ & Flame Dancer™ are registered trademarks. Our designs and products are protected with patents and design applications.

Please visit our website for information on installation manuals, warranty and dealer locations etc.